

DS-2CC1173P(N)-VF(IR) Weather-proof IR Bullet Camera

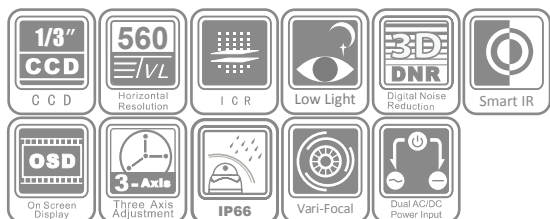

Specifications

DS-2CC1173P(N)-VF(IR)	
Camera	
Image sensor	1/3" SONY Super HAD CCD II
Signal system	PAL/NTSC
Effective pixels	PAL: 752 (H) × 582 (V) NTSC: 768 (H) × 494 (V)
Min. illumination	Color: 0.1 Lux @ (F1.2, AGC ON), 0.0003 Lux @ (F1.2, AGC ON, sensitivity × 256) Color: 0.14 Lux @ (F1.4, AGC ON), 0.0004 Lux @ (F1.4, AGC ON, sensitivity × 256) B/W: 0.01 Lux @ (F1.2, AGC ON), 0.00003 Lux @ (F1.2, AGC ON, sensitivity × 256) B/W: 0.014 Lux @ (F1.4, AGC ON), 0.00004 Lux @ (F1.4, AGC ON, sensitivity × 256) -IR: 0.1 Lux @ (F1.2, AGC ON), 0.0003 Lux @ (F1.2, AGC ON, sensitivity × 256), 0 Lux with IR 0.14 Lux @ (F1.4, AGC ON), 0.0004 Lux @ (F1.4, AGC ON, sensitivity × 256), 0 Lux with IR
Shutter time	PAL: 1/50 s to 1/100,000 s NTSC: 1/60 s to 1/100,000 s
Lens	2.8 ~ 12 mm @ F1.4 Angle of view: 92° ~ 27.2°
Lens mount	φ 14
Auto iris	DC drive
Angle adjustment	Pan: 0 ~ 360°, Tilt: 0 ~ 90°, Rotation: 0 ~ 360°
Day & night	IR cut filter with auto switch
Horizontal resolution	560 TVL (Color), 600 TVL (B/W)
Synchronization	Internal/Power synchronization
Video output	1 Vp-p composite output (75 Ω/BNC); Test monitor out [1Vp-p composite output (75 Ω/BNC), device line]
S/N ratio	More than 52 dB
Menu	
Camera ID	On / off (15 letters, adjusted position)
Auto gain control	Low / middle / high / off
D/N mode	Auto / day / night
Auto white balance	Auto trace WB1 / auto trace WB2 / manual / auto control
Privacy mask	On / off, maximum 8 zones
Motion detection	On / off
BLC	Area / value / off
Eclipse	Value
Digital WDR	Indoor / outdoor / off
Anti-flicker	On / off
Language	English / Chinese
Video	SMART IR, Digital Wide Dynamic Range, Excessive High Light Compensation, Gamma Correction, Digital Zoom, Digital Noise Reduction, POS/NEG, Mirror, Sharpness, Y, C, Defect Pixel Correction
General	
Operating conditions	-10°C ~ 60°C (14°F ~ 140°F) Humidity 90% or less (non-condensing)
Power supply	24 VAC ± 10%, 12 VDC ± 10%
Weather-proof rating	IP66
IR range	approx. 20 ~ 30 meters
Power consumption	Max. 10 W with IR cut filter on
Dimensions	96.9 x 84.2 x 315.4 mm (3.81" × 3.31" × 12.42")
Weight	2100g (4.62 lbs)

Key features

- 1/3" Sony Super HAD CCD II
- Low illumination
- True day / night
- 3-axis adjustment
- 3D digital noise reduction
- IP66 rating

Dimensions

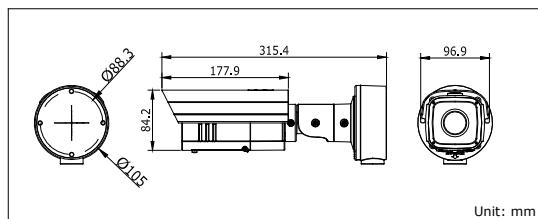

Unit: mm

Available models

DS-2CC1173P-VF, DS-2CC1173N-VF, DS-2CC1173P-VFIR, DS-2CC1173N-VFIR