

DS-2CC1191P(N)-A 650TVL Box Camera

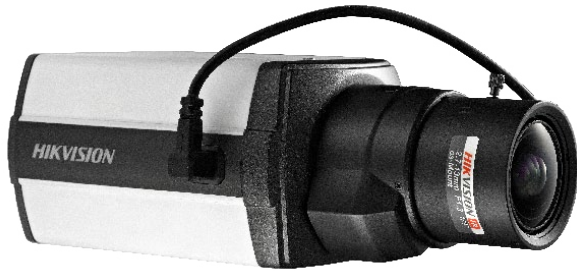

Specifications

DS-2CC1191P(N)-A	
Camera	
Image sensor	1/3" Sony Exview HAD CCD II
Signal system	PAL/NTSC
Effective pixels	PAL: 976 (H) × 582 (V) NTSC: 976 (H) × 494 (V)
Min. illumination	Color: 0.001 lux@F1.2, AGC on B/W: 0.0001 lux@F1.2, AGC on
Shutter time	PAL: 1/50 s to 1/100,000 s NTSC: 1/60 s to 1/100,000 s
Lens mount	C/CS mount
Auto iris	DC/Video drive
Day & night	IR cut filter with auto switch
Horizontal resolution	Color: 650 TVL, B/W: 700 TVL
Synchronization	Internal / Power synchronization
Video output	1Vp-p composite output (75 Ω / BNC)
S/N ratio	More than 62dB
Menu	
Camera ID	On / off (16 letters, adjusted position)
Auto gain control	Low / middle / high / off
D/N mode	Auto1 / auto2 / day / night
White balance	Auto trace WB1 / auto trace WB2 / manual / auto Control
Private mask	On / off, maximum 8 zones
Motion detection	Mode 1 / mode 2 / off
BLC	Area / value / off
RS-485	Address / protocol / baud rate
Language	English / Chinese
Function	SMART IR, digital WDR, Eclipse, digital noise reduction, sharpness, brightness, saturation, resolution, mirror, defect pixel correction
General	
Operating conditions	-10°C ~ 60°C (14°F ~ 140°F) Humidity 90% or less (non-condensing)
Power supply	24 VAC ± 10%, 12 VDC ± 10%
Power consumption	5W max. (10W max. with IR cut filter on)
Dimensions	69 x 56 x 113.3 mm (2.72" × 2.20" × 4.46")
Weight	400g (0.88 lbs)

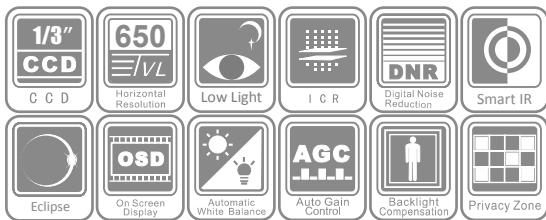

Key features

- 1/3" Sony Exview HAD CCD II
- 650 TVL high resolution
- Super low illumination
- True day / night
- Smart IR
- Digital wide dynamic range

Dimensions

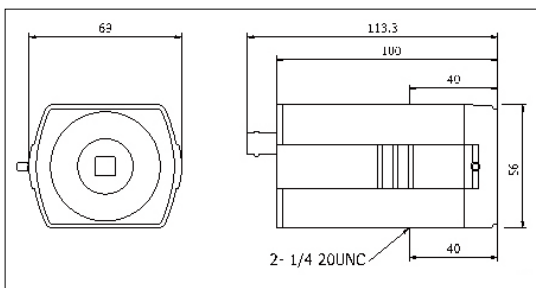

Available models

DS-2CC1191P-A, DS-2CC1191N-A

Accessories

