



This kit is configured for places that require multiple indoor antenna and multiple carrier operation. If you have more than one tower that you receive cell signal from, then this omnidirectional outdoor antenna makes things simple for installation. Additionally the amplifier is 75 db adjustable gain AG Pro system allows for greater flexibility during installation.

Key Features

- High gain 75db System, with optional manual gain adjust
- Automatic surge protected amplifiers with auto shut down, in case of overload along with **auto reset**
- Omni directional outdoor antenna suitable for installing multiple systems in one building without over loading the cell tower
- Multiple carrier and multiple users operating wireless at the same time
- Both voice, 2g, 3g data signal boost achieved
- No software required, just plug and play installation
- Operates independent of carriers, hence greater flexibility to change carriers as you see fit
- Does not require internet connection to operate

Kit Includes

- 75 dB high gain adjustable gain control system with automatic shut down circuit
- Dual band omni directional fiber glass antenna
- 2 x Dome antenna to be mounted on the ceiling of the inside
- 1x 75 ft LMR low loss cable
- 2 x 50 ft LMR low loss cable
- [Installation Manual](#) and other installation accessories

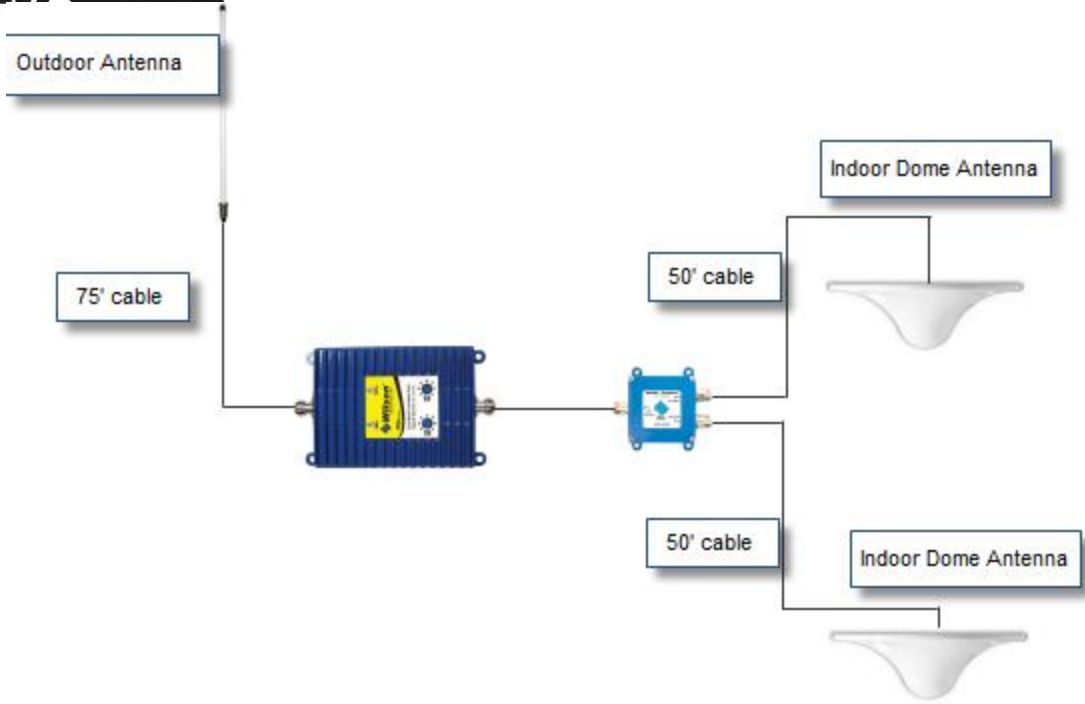

Technical Specification

Part Number		801106/801306
Frequency		824-835 MHz, 869-880 MHz
Gain		75 dB
Max Output		3 watts
Max RF		+ 30 dBm / + 30 dBm
Noise Figure		3-4 dB typical
Flatness		± 2.5 dB
Isolation		> 90 dB
Power Requirements		Input: 100-240 V AC 50/60 Hz 0.6 A / Output: 6 V DC 3 A
Connectors		N-Female 50 ohms
Dimensions		4.5 x 3.5 x 1.25 (inch) / 14.2 x 9.1 x 4.4 (cm)
Weight		1.5 lbs / 0.7 kg